

Junction of Tudor Avenue with New Hall Lane - Extended Bus Stop Clearway, New NWAAT & H-Bar

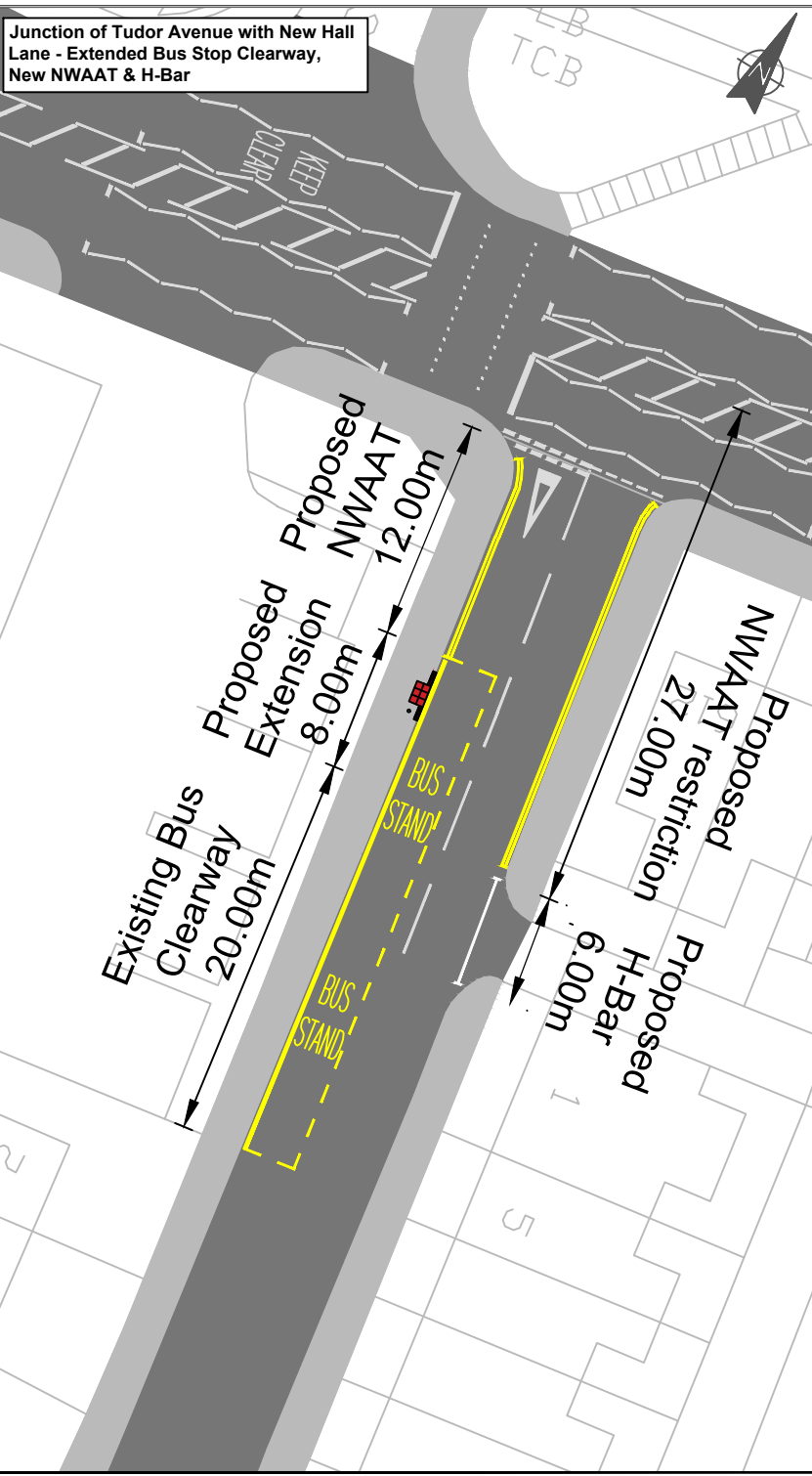

Junction of Cairnsmore Avenue with Tudor Avenue - New Bus Stop Clearway



*Based on Ordnance Survey mapping with the permission of the Controller of Her Majesty's Stationery Office. © Crown copyright. Unauthorised reproduction infringes Crown copyright and may lead to prosecution or civil proceedings.

Lancashire County Council Licence No. LA100023320

A	14/09/2022	Amended bus stop location at Tudor Avenue & added post & spacer to Cairnsmore	KHOLLIDAY	SPYRAH
NO.	DATE	AMENDMENT DETAILS	CHECKED BY	DRAWN BY

REVISIONS

Lancashire County Council Design and Construction

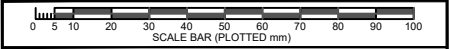

PROJECT TITLE BUS SERVICE IMPROVEMENT PLAN 2022
TUDOR AVENUE PARKING IMPROVEMENTS

DRAWING TITLE TUDOR AVENUE & CAIRNSMORE AVENUE
PROPOSED TRAFFIC REGULATION ORDERS

DRAWN BY	SPYRAH	DATE	SEPT 2022
CHECKED BY	KHOLLIDAY	DRAWING No.	BSIPS 217 0100 01
PROJECT No.	BSIPS - 217	SHEET No.	1 of 1.
SCALE @ A2	1:200	ISSUE PURPOSE	CONSULTATION